

## Residence hall supports the academic mission

The Alice Paul Residence Hall creates a residential setting that supports the academic mission of Swarthmore College. This modern building contributes to a campus notable for its landscape and its long tradition of stone buildings.

“Swarthmore College believes that residence hall living enhances education and contributes to an individual’s academic, social, and personal development,” according to C. Stuart Hain, Associate Vice President for Facilities and Services.

Collaborating with Swarthmore’s steering committee, the architect developed a concept for the hall module to encourage interaction among students through wide corridors, strategic location of entries and stairs, and generous common space on each floor. A two-story main lounge is the “living room” for the building, and features an open stairway which allows students to “see and be seen” as they enter the building.

The campus’ most iconic image is the Main Lawn, a three-sided open space that opens the campus to the town. A land-use study identified this as a prevalent typology occurring throughout the campus. The residence halls adopted this typology, defining three sides of a courtyard open to the western sun and views of the Main Lawn. Common spaces and building entrances open directly to the courtyard. The main lounge, in-

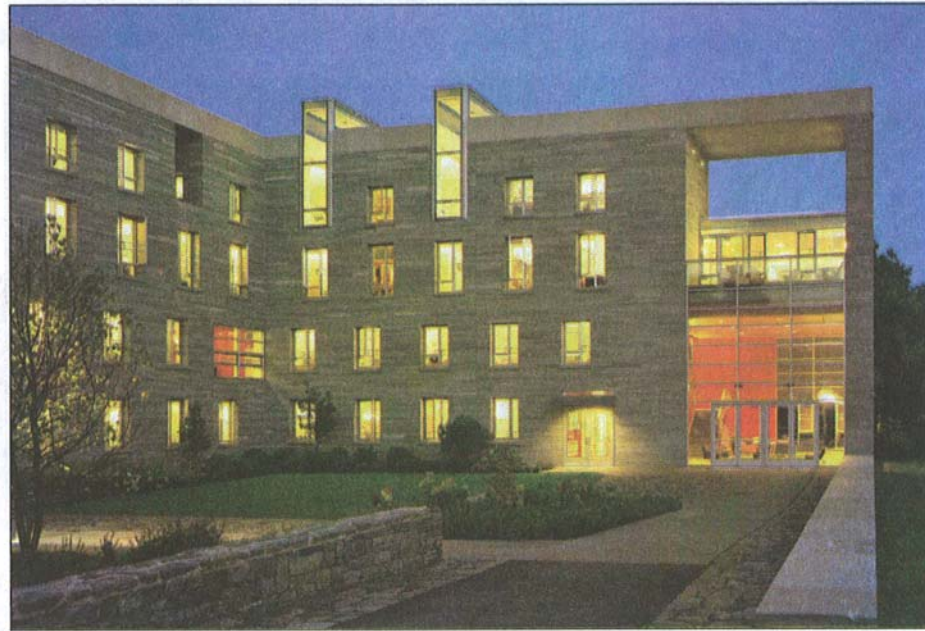

*Photo by Robert Benson*

cluding a roof deck and upper floor lounge, acts as a beacon terminating a walk along the east edge of the Main Lawn.

Designed to be LEED® certified, the residence hall incorporates many sustainable design features, including a green roof. The building uses up to 30% less energy than code standards and uses high performance low-e glass with fritted glass intended to reduce bird impacts.

The jury said, “This is one of the best examples of a more traditional vernacular, introducing modernism . . . great landscaping details . . . sets a bar for the next development . . .”

Project Team: *Swarthmore College with William L. Rawn Associates Architects, Inc.* and *LeMessurier Engineers*, structural engineering; *Cosentini Associates, Inc.*, M/E/P; and *Olin Partnership*, landscape architecture.